

NOTES: THIS DRAWING IS NOT TO SCALE.  
 CHARACTERISTICS AND DIMENSIONS OF FINISHED PRODUCT MAY VARY.

NOTES:  
 1.) COMPARTMENT DIMENSIONS REFLECT OPENING CLEARANCE.  
 2.) APPROXIMATE COMPARTMENT DEPTH=20 1/2"DEEP.  
 3.) MODULE DIMENSIONS=148 L x 96 W x 89 H  
 4.) INTERIOR MODULE HEAD ROOM=88"H.  
 5.) ALL 9x7 LIGHTS TO BE WHELEN 900 SERIES LIGHTS.  
 6.) DOUBLE STAINLESS THRESHOLDS.  
 7.) STYROFOAM INSULATION, WALLS & CEILING.

Rev.#	Revision Description	Date	Rev'd App'vd
3			
2			
1			
<p>Stock/Job#: _____ Drawing# 20-1-2148-W-100 Cust. App'v/Date# _____ Dealer App'v/Date: _____</p> <p>Osage Dealer: _____</p> <p>End Customer: _____</p> <p><b>NOTICE</b></p> <p>This drawing and/or the information hereon is the exclusive property of Osage Industries and shall not be reproduced, used or disclosed without the authorized written consent of Osage Industries.</p> <p>Drawn By: S.A.H. Date: 06-05-19 Scale: NOT TO SCALE</p> <p>Drawing Description: EXTERIOR LAYOUT TYPE-I WARRIOR</p> <p>Osage Industries, Inc.        TWIN RIDGE ROAD        P.O. BOX 718        LINN, MO. 65051</p>			
Rev.#	Revision Description	Date	Rev'd App'vd
1			

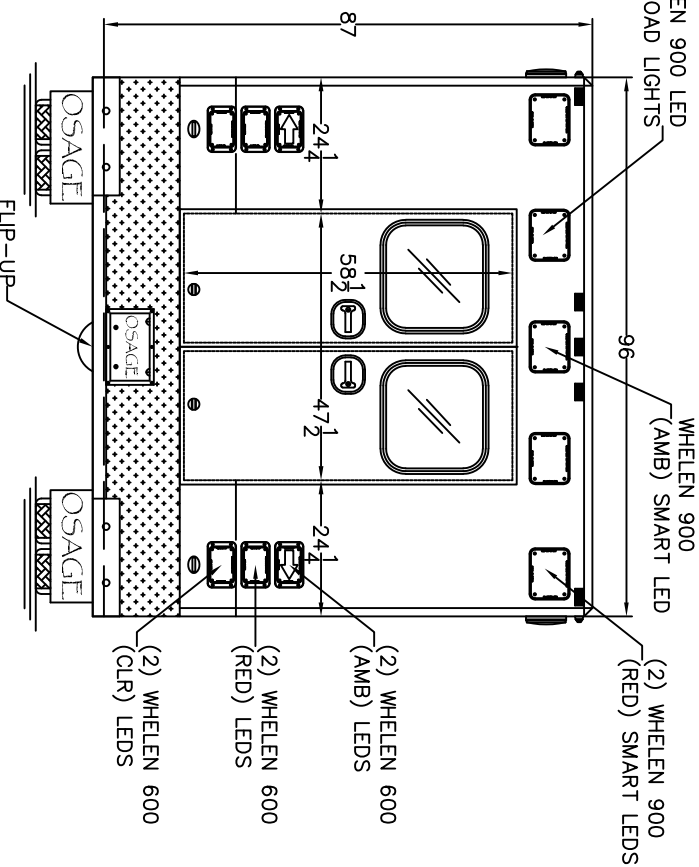
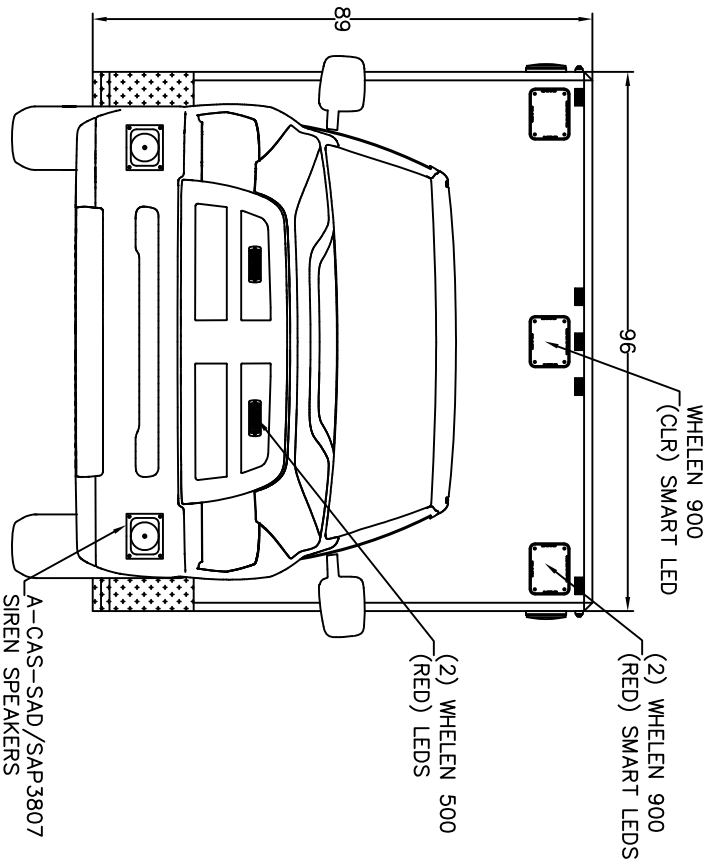

NOTES: THIS DRAWING IS NOT TO SCALE.  
CHARACTERISTICS AND DIMENSIONS OF FINISHED PRODUCT MAY VARY.

- NOTES:
- 1.) COMPARTMENT DIMENSIONS REFLECT OPENING CLEARANCE.
  - 2.) APPROXIMATE COMPARTMENT DEPTH=20 1/2" DEEP.
  - 3.) MODULE DIMENSIONS=148"L x 96"W x 89"H
  - 4.) INTERIOR MODULE HEAD ROOM=68"H.
  - 5.) ALL 9x7 LIGHTS TO BE WHELEN 900 SERIES LIGHTS.
  - 6.) DOUBLE STAINLESS THRESHOLDS.
  - 7.) STYROFOAM INSULATION, WALLS & CEILING.

3			
2			
1			
Rev.#	Revision Description	Date	Rev'd App'vd

Stock/Job#:	Drawing#	Cust. App'v/Date#	Deal'r App'v/Date:
Osage Dealer:	20-1-2148-W-100		
End Customer:	<b>Osage Industries, Inc.</b> TWIN RIDGE ROAD P.O. BOX 718 LINN, MO. 65051		
NOTICE	Drawn By:	Date:	Scale:
This drawing and/or the information hereon is the exclusive property of Osage Industries and shall not be reproduced, used or disclosed without the authorized written consent of Osage Industries.	S.A.H.	06-05-19	NOT TO SCALE
	Drawing Description:		Revision#
	EXTERIOR LAYOUT, FRONT/REAR TYPE-I WARRIOR		1

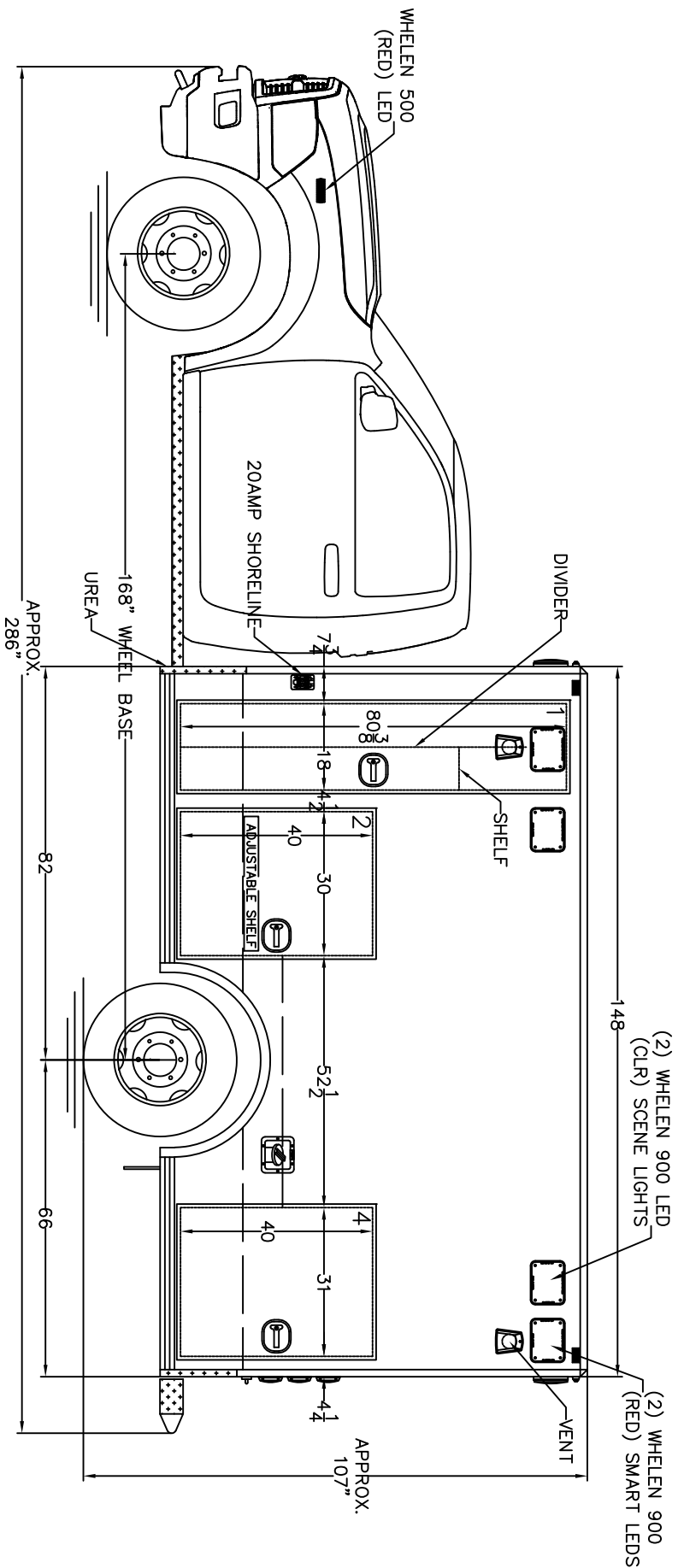

NOTES: THIS DRAWING IS NOT TO SCALE.  
 CHARACTERISTICS AND DIMENSIONS OF FINISHED PRODUCT MAY VARY.

NOTES:

- 1.) COMPARTMENT DIMENSIONS REFLECT OPENING CLEARANCE.
- 2.) APPROXIMATE COMPARTMENT DEPTH=20 1/2" DEEP.
- 3.) MODULE DIMENSIONS=148"L x 96"W x 89"H
- 4.) INTERIOR MODULE HEAD ROOM=68"H.
- 5.) ALL 9x7 LIGHTS TO BE WHELEN 900 SERIES LIGHTS.
- 6.) DOUBLE STAINLESS THRESHOLDS.
- 7.) STYROFOAM INSULATION, WALLS & CEILING.

3			
2			
1			
Rev.#	Revision Description	Date	Rev'd App'vd

Stock/Job#:	Drawing#:	Cust. App'v/Date#:	Deal'r App'v/Date:
Osage Dealer:	20-1-2148-W-100		
End Customer:	TWIN RIDGE ROAD		
	Osage Industries, Inc.		
	P.O. BOX 718		
	LINN, MO. 65051		
<b>NOTICE</b>			
This drawing and/or the information hereon is the exclusive property of Osage Industries and shall not be reproduced, used or disclosed without the authorized written consent of Osage Industries.			
Drawn By:	S.A.H.	Date:	06-05-19
Drawing Description:	EXTERIOR LAYOUT, STREETSIDE TYPE-1 WARRIOR		
Scale:	NOT TO SCALE		
Revision#:	1		

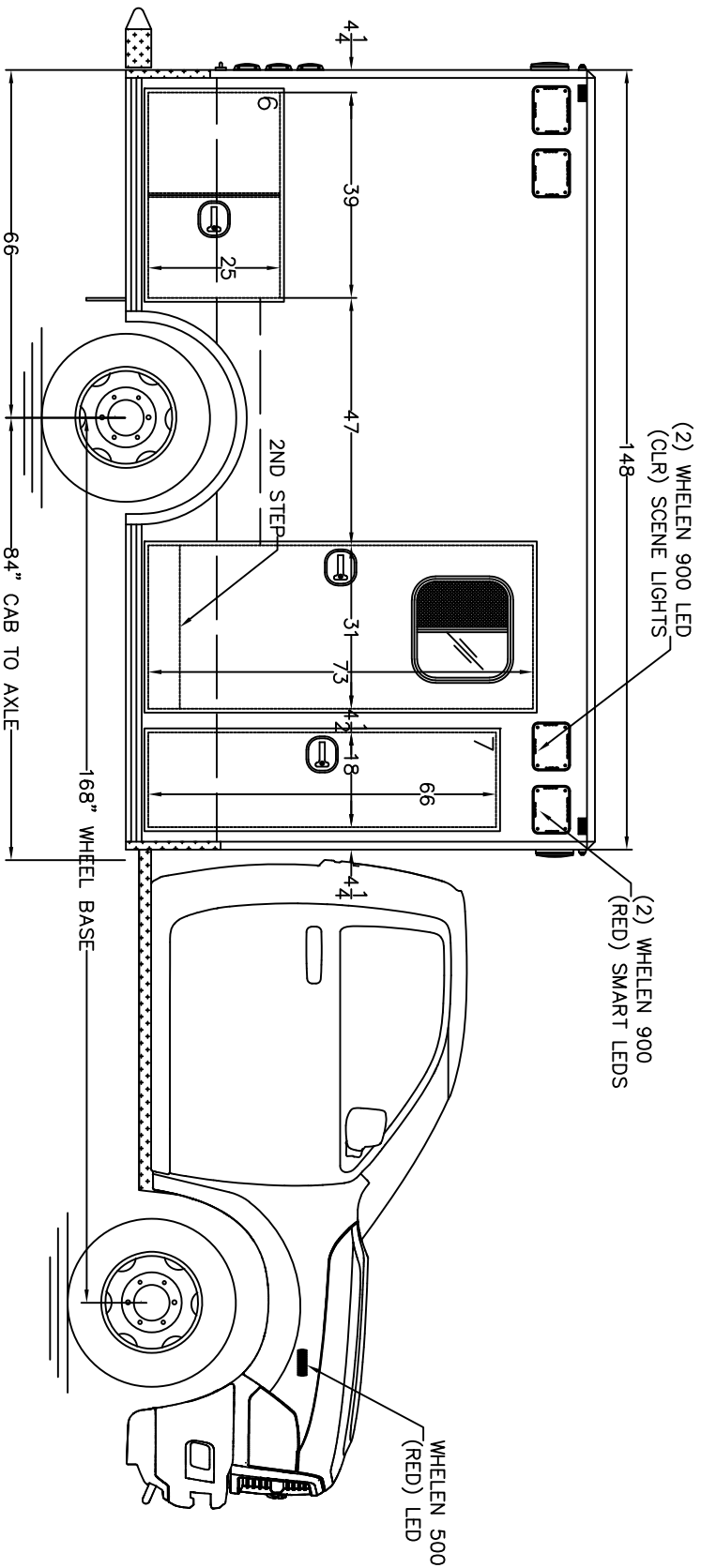

NOTES: THIS DRAWING IS NOT TO SCALE.  
 CHARACTERISTICS AND DIMENSIONS OF FINISHED PRODUCT MAY VARY.

NOTES:

- 1.) COMPARTMENT DIMENSIONS REFLECT OPENING CLEARANCE.
- 2.) APPROXIMATE COMPARTMENT DEPTH=20 1/2" DEEP.
- 3.) MODULE DIMENSIONS=148"L x 96"W x 89"H
- 4.) INTERIOR MODULE HEAD ROOM=68"H.
- 5.) ALL 9x7 LIGHTS TO BE WHELEEN 900 SERIES LIGHTS.
- 6.) DOUBLE STAINLESS THRESHOLDS.
- 7.) STYROFOAM INSULATION, WALLS & CEILING.

Rev.#	Revision Description	Date	Rev'd	App'vd
3				
2				
1				

Stock/Job#:	Drawing#	Cust. App'v/Date#	Deal'r App'v/Date:
Osage Dealer:	20-1-2148-W-100		
End Customer:	<b>Osage Industries, Inc.</b> TWIN RIDGE ROAD P.O. BOX 718 LINN, MO. 65051		
<b>NOTICE</b>			
This drawing and/or the information hereon is the exclusive property of Osage Industries and shall not be reproduced, used or disclosed without the authorized written consent of Osage Industries.			
Drawn By:	S.A.H.	Date:	06-05-19
Drawing Description:	EXTERIOR LAYOUT, CURBSIDE TYPE-I WARRIOR		Scale: NOT TO SCALE
Revision#			1



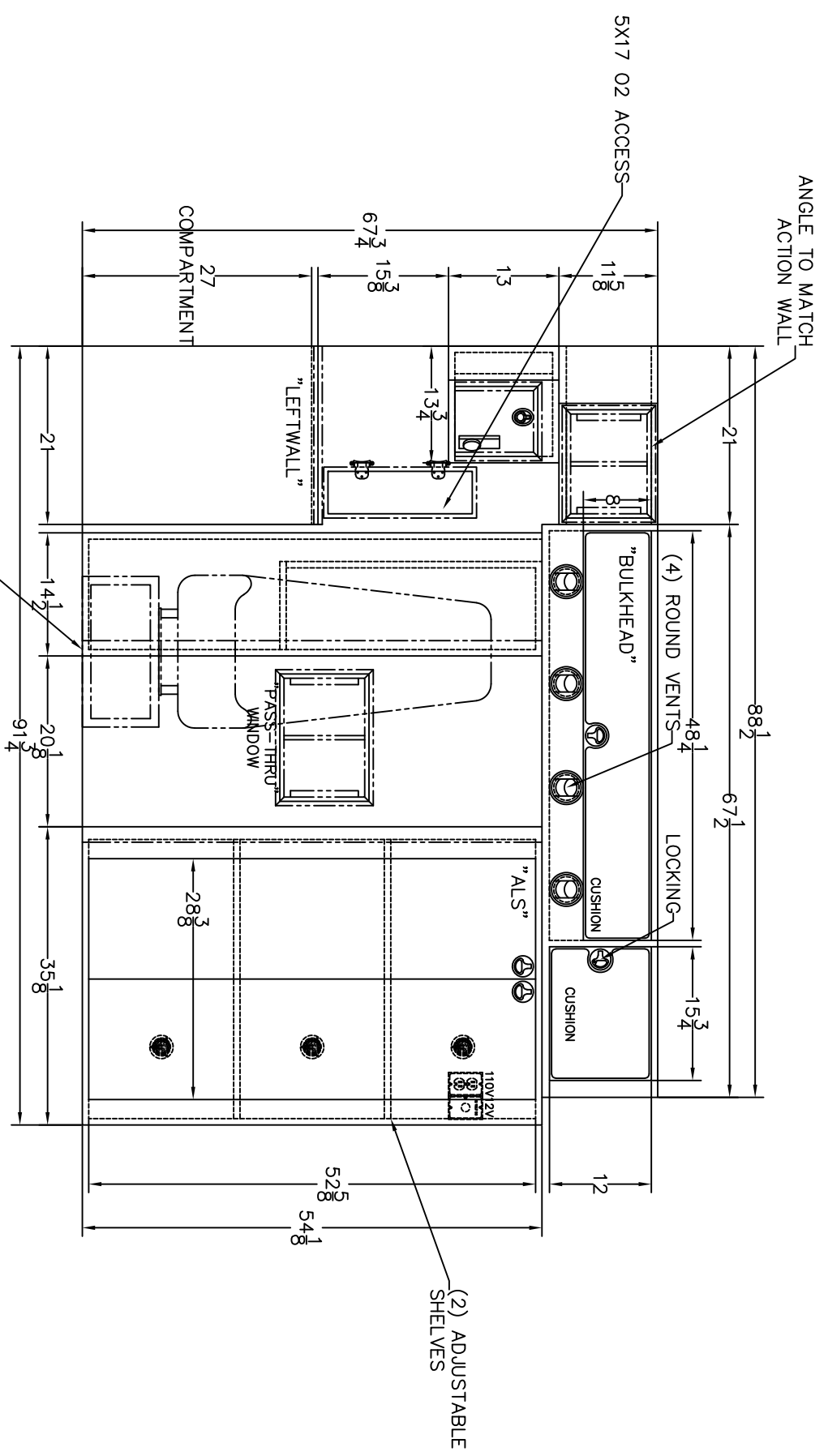

NOTES: THIS DRAWING IS NOT TO SCALE.  
 CHARACTERISTICS AND DIMENSIONS OF FINISHED PRODUCT MAY VARY.  
 NOTES: CABINET DEPTHS REPRESENT DIMENSION FROM INSIDE REAR TO FRONT FACE OF CABINETS, WITHOUT TRIM.  
 ACTUAL WORKING DEPTH WILL BE LESS THAN DIMENSION SHOWN UNLESS OTHERWISE SPECIFIED.

3			
2			
1			
Rev.#	Revision Description	Date	Rev'd App'vd

Stock/Job#:	Drawing#	Cust. App'v/Date#	Decl'r App'v/Date:
Osage Dealer:	20-1-2148-W-102		
End Customer:	TWINRIDGE ROAD		
	<b>Osage Industries, Inc.</b>		
	P.O. BOX 718		
	LINN, MO. 65051		
<b>NOTICE</b>			
This drawing and/or the information hereon is the exclusive property of Osage Industries and shall not be reproduced, used or disclosed without the authorized written consent of Osage Industries.			
Drawn By:	S.A.H.	Date:	06-05-19
Drawing Description:	FORWARD INTERIOR TYPE-I WARRIOR		Scale: NOT TO SCALE
			Revision#
			1

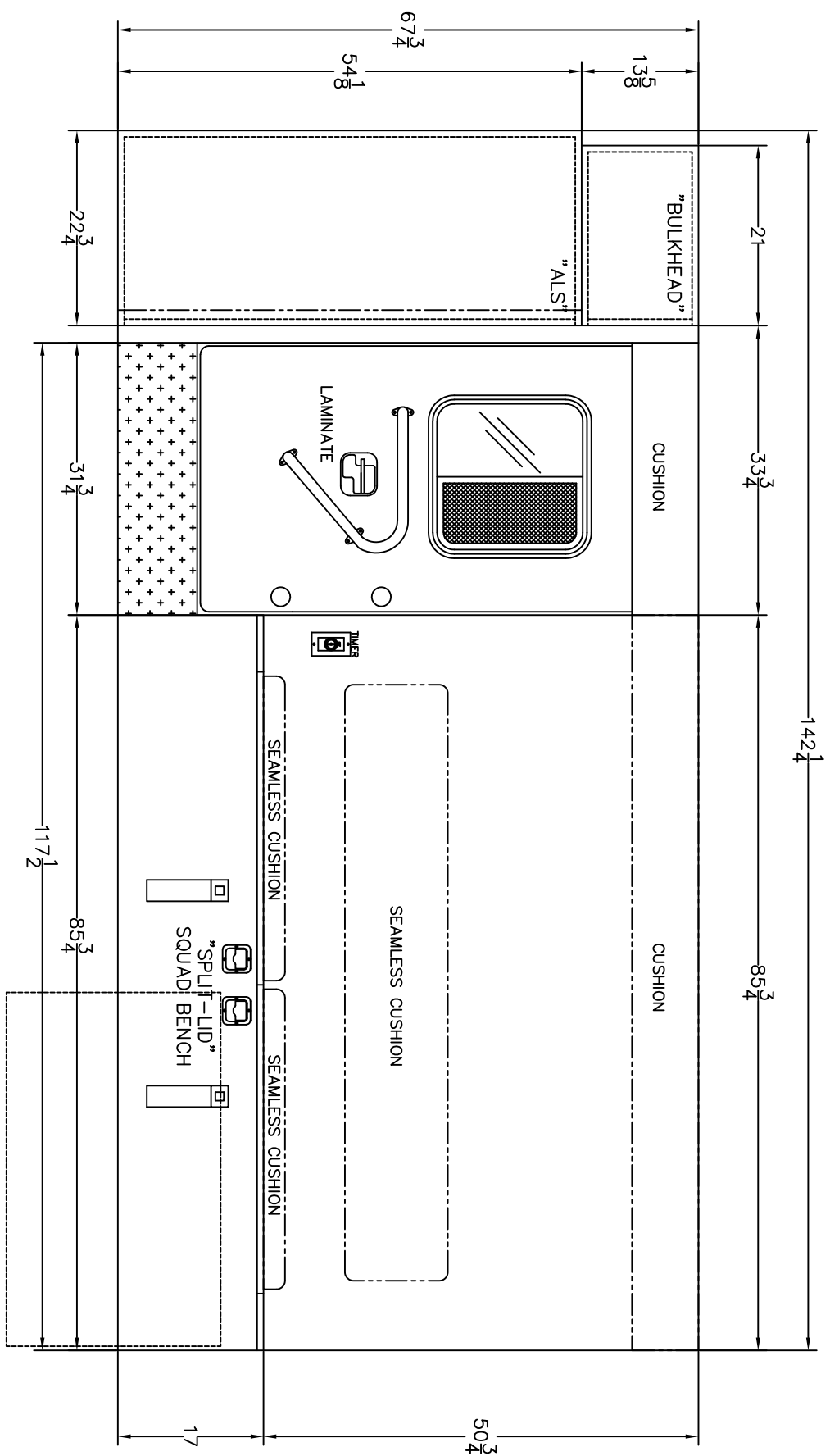

NOTES: THIS DRAWING IS NOT TO SCALE.  
 CHARACTERISTICS AND DIMENSIONS OF FINISHED PRODUCT MAY VARY.  
 NOTES: CABINET DEPTHS REPRESENT DIMENSION FROM INSIDE REAR TO FRONT FACE OF CABINETS, WITHOUT TRIM. ACTUAL WORKING DEPTH WILL BE LESS THAN DIMENSION SHOWN UNLESS OTHERWISE SPECIFIED.

3				
2				
1				
Rev.#	Revision Description	Date	Rev'd	App'vd

Stock/Job#:	Drawing#	Cust. App'v/Date#	Deal'r App'v/Date:
Osage Dealer:	20-1-2148-W-103		
End Customer:	TWINRIDGE ROAD		
	<b>Osage Industries, Inc.</b>		
	P.O. BOX 718		
	LINN, MO. 65051		
NOTICE	Drawn By: S.A.H.	Date: 06-05-19	Scale: NOT TO SCALE
This drawing and/or the information hereon is the exclusive property of Osage Industries and shall not be reproduced, used or disclosed without the authorized written consent of Osage Industries.	Drawing Description:		Revision#
	CURBSIDE INTERIOR		1
	TYPE-1 WARRIOR		

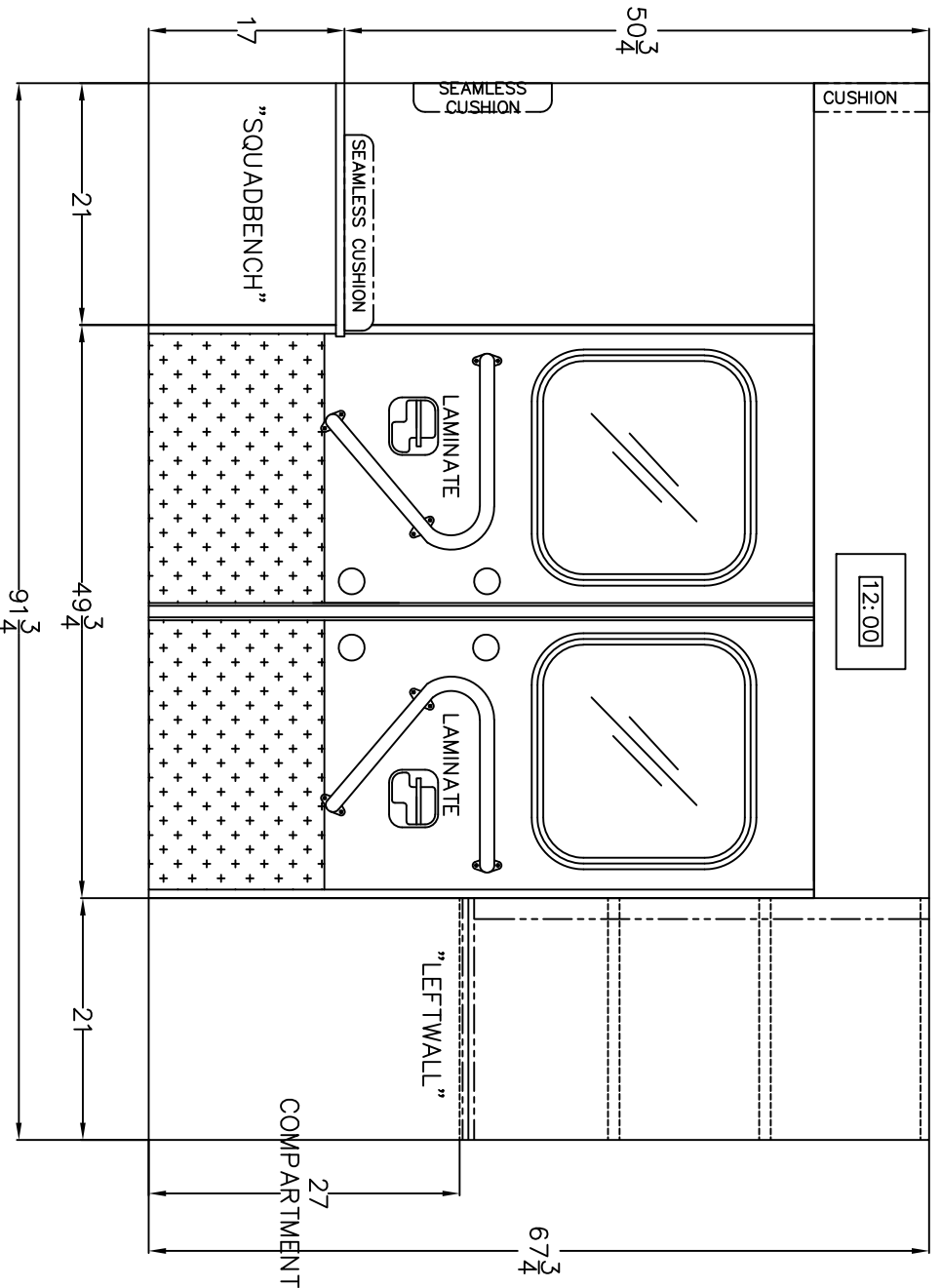

NOTES: THIS DRAWING IS NOT TO SCALE.  
 CHARACTERISTICS AND DIMENSIONS OF FINISHED PRODUCT MAY VARY.  
 NOTES: CABINET DEPTHS REPRESENT DIMENSION FROM  
 INSIDE REAR TO FRONT FACE OF CABINETS, WITHOUT TRIM.  
 ACTUAL WORKING DEPTH WILL BE LESS THAN DIMENSION  
 SHOWN UNLESS OTHERWISE SPECIFIED.

3			
2			
1			
Rev.#	Revision Description	Date	Rev'd App'vd

Stock/Job#:	Drawing#:	Cust. App'v/Date#:	Deal'r App'v/Date:
Osage Dealer:	20-1-2148-W-104		
End Customer:			
<b>NOTICE</b>			
This drawing and/or the information hereon is the exclusive property of Osage Industries and shall not be reproduced, used or disclosed without the authorized written consent of Osage Industries.			
Drawn By:	Date:		
S.A.H.	06-05-19		
Drawing Description:			
REARWARD INTERIOR TYPE-I WARRIOR			
Scale: NOT TO SCALE		Revision#	
		1	

**Osage Industries, Inc.**  
 TWINRIDGE ROAD  
 P.O. BOX 718  
 LINN, MO. 65051



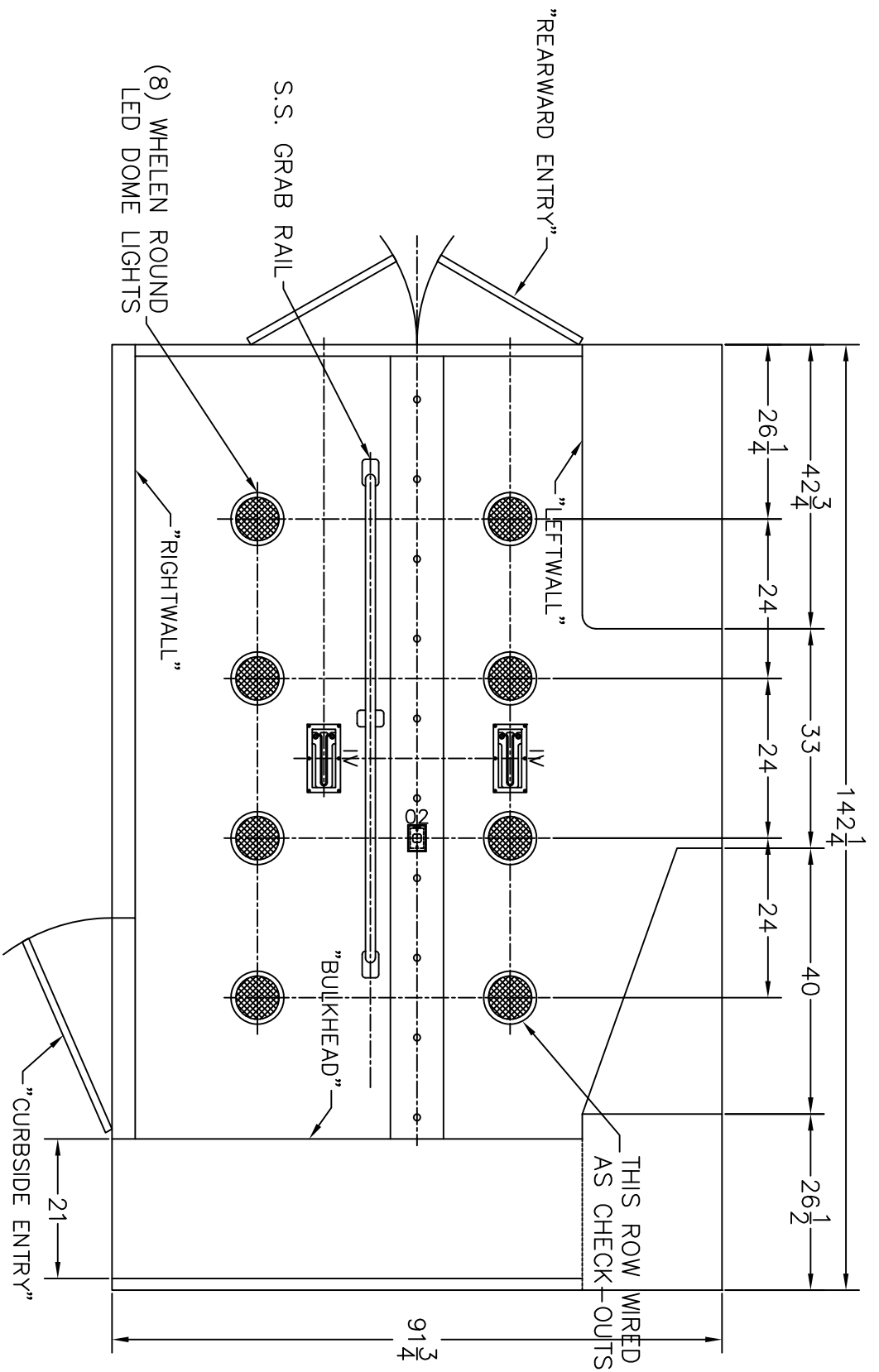

NOTES: THIS DRAWING IS NOT TO SCALE.  
 CHARACTERISTICS AND DIMENSIONS OF FINISHED  
 PRODUCT MAY VARY.

3			
2			
1			
Rev.#	Revision Description	Date	Rev'd App'vd

Stock/Job#:	Drawing#:	Cust. App'v/Date#:	Deal'r App'v/Date:
Osage Dealer:	20-1-2148-W-105		
End Customer:			
<b>NOTICE</b>			
<small>This drawing and/or the information hereon is the exclusive property of Osage Industries and shall not be reproduced, used or disclosed without the authorized written consent of Osage Industries.</small>			
Drawn By:	Date:	Scale:	
S.A.H.	06-05-19	NOT TO SCALE	
Drawing Description:	<b>Osage Industries, Inc.</b> TWINRIDGE ROAD P.O. BOX 718 LINN, MO. 65051		Revision#:
CEILING LAYOUT TYPE-I WARRIOR			1



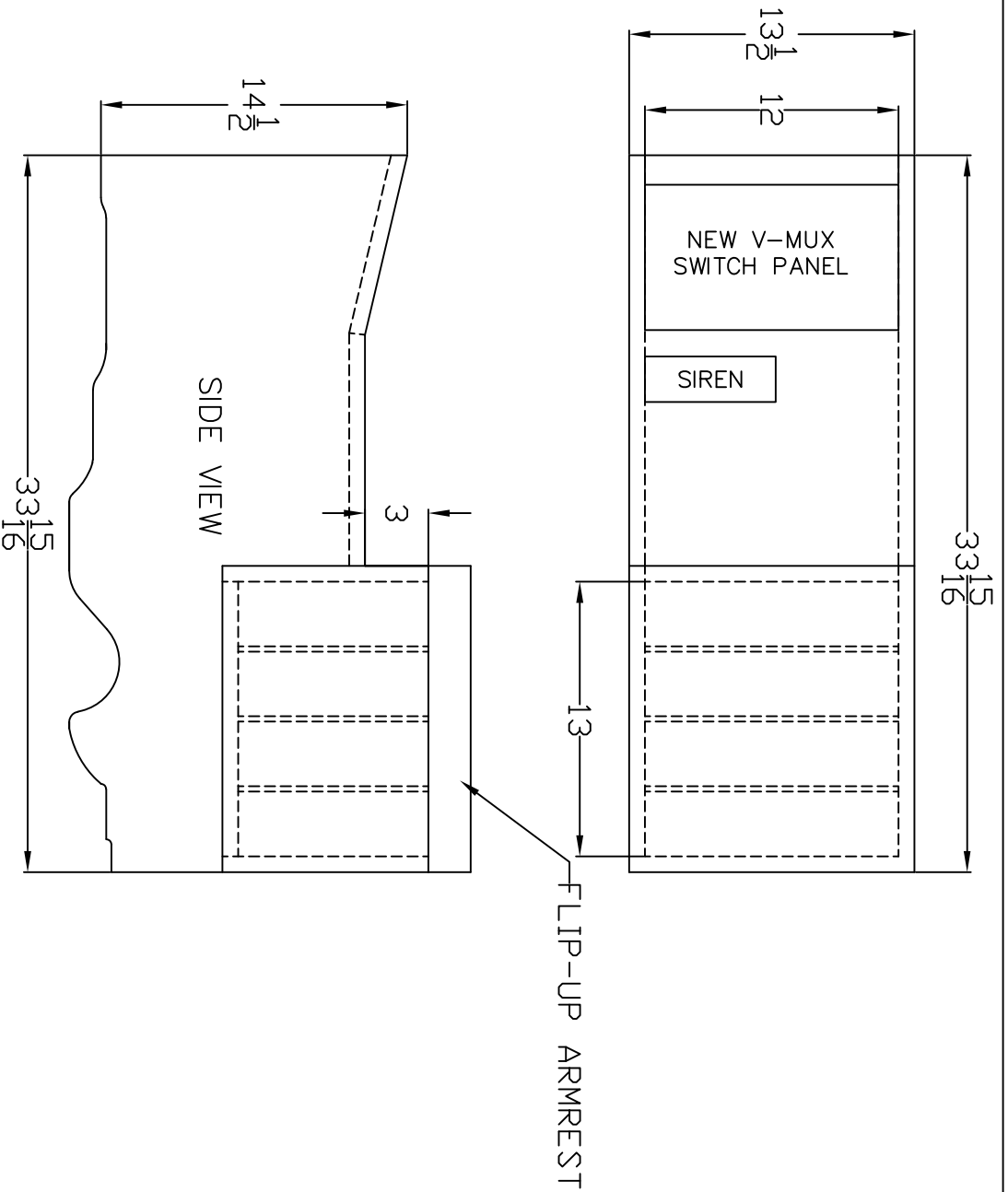

NOTES: THIS DRAWING IS NOT TO SCALE.  
 CHARACTERISTICS AND DIMENSIONS OF  
 FINISHED PRODUCT MAY VARY.

3			
2			
1	PRODUCTION DRAFT		SAH
Rev.#	Revision Description	Date	Rev'd App'vd

Stock/Job#:	Drawing#	Cust. App'v/Date#	Deal'r App'v/Date:
Osage Dealer:	20-1-2148-W-107A		
End Customer:	<b>Osage Industries, Inc.</b> TWINRIDGE ROAD P.O. BOX 718 LINN, MO. 65051		
<b>NOTICE</b> This drawing and/or the information hereon is the exclusive property of Osage Industries and shall not be reproduced, used or disclosed without the authorized written consent of Osage Industries.			
Drawn By:	S.A.H.	Date:	06-05-19
Drawing Description:	OSAGE RADIO CONSOLE		Scale: NOT TO SCALE
	TYPE I, PASS-THROUGH		Revision#
			1

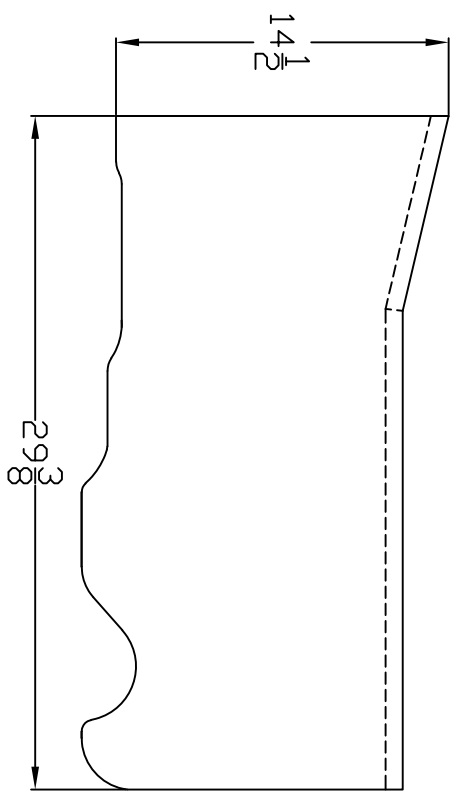
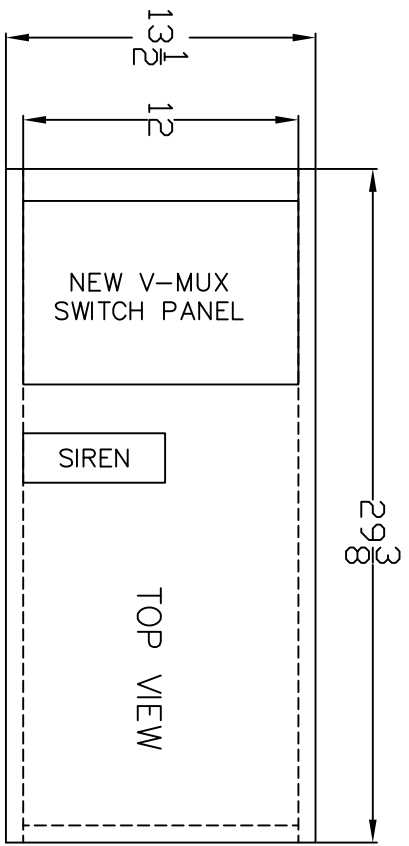

NOTES: THIS DRAWING IS NOT TO SCALE.  
 CHARACTERISTICS AND DIMENSIONS OF  
 FINISHED PRODUCT MAY VARY.

3				
2				
1	PRODUCTION DRAFT		SAH	
Rev.#	Revision Description	Date	Rev'd	App'vd

Stock/Job#:	Drawing#	Cust. App'v/Date#	Deal'r App'v/Date:
Osage Dealer:	20-1-2148-W-107B		
End Customer:	<b>Osage Industries, Inc.</b> TWINRIDGE ROAD P.O. BOX 718 LINN, MO. 65051		
<b>NOTICE</b> This drawing and/or the information hereon is the exclusive property of Osage Industries and shall not be reproduced, used or disclosed without the authorized written consent of Osage Industries.			
Drawn By:	Date:	Scale:	
S.A.H.	06-05-19	NOT TO SCALE	
Drawing Description:	OSAGE RADIO CONSOLE		Revision#
	TYPE I, CRAWL-THROUGH		1